

PHYSICAL DIMENSIONS

Module			CM-151	
			mm	inch
Module Length	+/- 4,0mm	A	1891	74.45
	+/- 5,1mm	B	1918,2	75.52
Port Projection	+1,3/-2,6mm	C	13,6	0.54
Side Port Dimension	+1,3/-2,6mm	D	309,1	12.17
	+0,3/-1,0mm	E	159	6.26
Module Diameter Top	+/-4,0mm	F	249	9.80
Module Diameter Mid	+/-1,5mm	G	211,5	8.33
Length of Diameter (G)	+/- 5,0mm	H	1246	49.06
	+/- 10,0mm	I	170	6.69
Module Diameter Bottom	+3,0/-1,0mm	J	233	9.17
Length of Cylindrical Diameter (J)	+/-10,0mm	K	105	4.13
		L	206	8.11
Grooved Fitting Feed/Reject (Qty 2)		M	DN-80	3-inch
Grooved Fitting Permeate		N	DN-50	2-inch

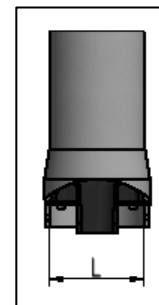

Certified according to:
 NSF 61, 372 & 419 (USA)
 Regulation 31 (UK)
 MOH (China)

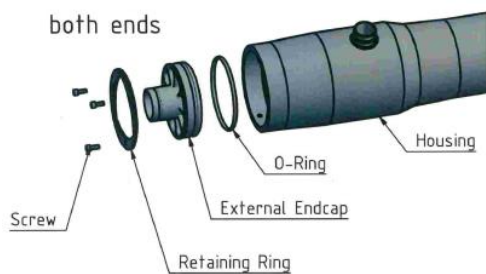
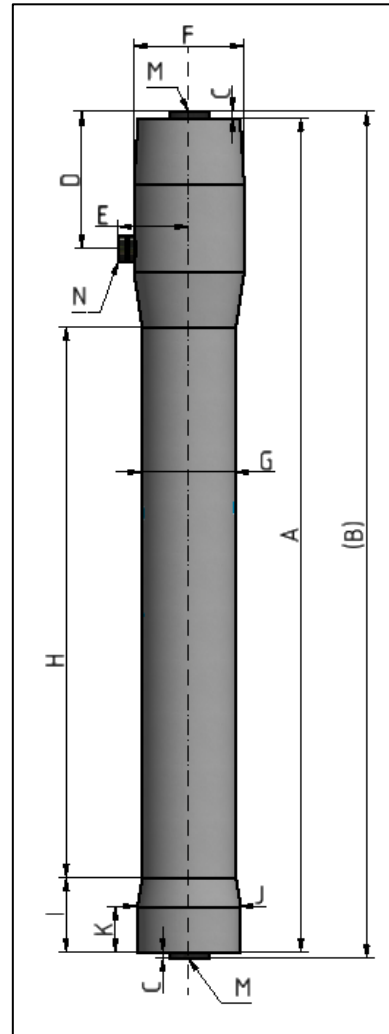

CM-151 Technical Data Sheet

Ceramic Ultrafiltration Monolith Module

Code: Q 1 VT PRD 151EN
 Page: 2/2
 Revision: 15

SPECIFICATIONS

Surface Area		24.3 m ²	262 ft ²
Nominal Channel Size (Hexagonal)		2.4 mm	0.09 in
Weight (+/- 5 kg)	Dry	78 kg	172 lbs.
	As Shipped	80 kg	176 lbs.
Maximum Module Hold Up Volume:		32 L	8.5 gal
Vessel Materials		Fiberglass Reinforced Plastic (FRP) Shell Fluor Elastomer (FKM) Seals Super-duplex 2507 Permeate Port CPVC or Noryl® Feed/Reject Ports	
Membrane Material		α – Al ₂ O ₃	
Membrane Nominal Pore Size		30 nm	
Module Operating Position		Vertical	

Operating Guidelines *

pH Range	2 - 12
Temperature Range (operation)	1 – 45°C (33°F – 113°F)
Approved Chemicals	Acids: Hydrochloric Acid, Sulfuric Acid, Citric Acid, Caustics: Sodium Hydroxide Oxidants: Sodium Hypochlorite, Chlorine Dioxide, Hydrogen Peroxide, Coagulants: Aluminum Chlorohydrate, Polyaluminum Chloride, Aluminum Sulfate, Ferric Chloride, Ferric Sulfate
Thermal Shock/Rate of Change	20°C instantaneous shock then 20°C / minute
Maximum System Pressure	7 bar (101 psi)
Filtration Flux	150 – 500 Lmh (88-294 GFD)
Backwash Flux	500 Lmh (294 GFD)
Filtration Mode	Dead End, Inside/Out

* Consult Nanostone to determine Process Specific Parameters

